

RB50/8 Fixed power wirewound resistors  
aluminium housed with screw leads (TOP)

## FIXED POWER WIREWOUND RESISTORS ALUMINIUM HOUSED WITH SCREW LEADS (TOP)

These resistors meet or exceed the requirements of  
MIL - PRF - 18546 G specifications

### ELECTRICAL SPECIFICATIONS

- Ohmic values
- E24 Series. For out of range or not standard ohmic values, consult ATE Technical Dept.
- Tolerance
- Standard 5%. Available on request up to 1%
- Temperature coefficient
- From  $\pm 100$  to  $\pm 30$  ppm from R10 to Rmax
- Dielectric strength
- 2500Vac / 3500Vac peak
- Insulation resistance
- 10000 M $\Omega$  minimum
- 1000 M $\Omega$  after moisture test
- Overload
- 5s at 5 times rated power
- Non inductive
- Models of equivalent physical and electrical specifications are also available with non inductive Ayrton-Perry winding
- Leads
- M4 threaded hole
- Terminal screw tightening torque
- 1,5Nm (static)

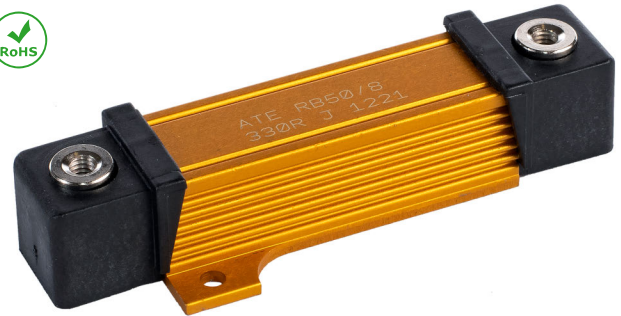

ATE Type	MIL-PRF 18546 G Type	Rated power (W)	Resistance range ( $\Omega$ )	Voltage limit (V)	Weight (g)	Heatsink dimensions (cm <sup>2</sup> x mm)
RB50/8	RE75	50	0.1 - 68K	1250	52	930 x 1.5

ATE Type	Dimensions (mm)															
	A	B	C	D	F	G	H	J	K	L	M	N	P	Q	R	S
RB50/8	21.5	16	29.2	16	2	39.7	50	79.5	3.2	14.5	M4	8	65	17.5	18.5	16.5
Tol.	$\pm 0.2$	$\pm 0.2$	$\pm 0.2$	$\pm 0.2$	$\pm 0.2$	$\pm 0.2$	$\pm 0.5$	$\pm 2$	$\pm 0.2$	$\pm 0.5$	-	-	$\pm 1$	$\pm 0.5$	$\pm 0.5$	$\pm 0.5$

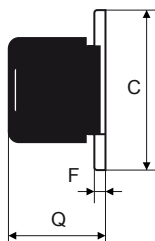

Connection screws supplied with the resistor

